

Wire Wound Chip Ceramic Inductor

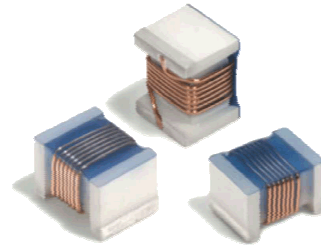

◆ **Features**

- 1、 Small chip suitable for surface mounting;
- 2、 High Q value and high self-resonant frequency with ceramic material;
- 3、 Tight inductance tolerance and stable inductance; at high frequency;
- 4、 RoHS Compliant.



◆ **Application**

- 1、 High frequency circuit in telecommunication and other equipments;
- 2、 Mobile phones such as GSM, CDMA, PDC, etc;
- 3、 Bluetooth, W-LAN, Broadband network.

◆ **PRODUCT IDENTIFICATION**

CMCW 1005 C 10N J S T
(1) (2) (3) (4) (5) (6) (7)

- (1) Series Type
- (2) Chip Size (mm) :Length X Width
- (3) Material Code
- (4) Inductance: 0N1=0.1nH; 4N7=4.7nH
10N=10nH; R10=100nH
1R0=1000nH
- (5) Inductance Tolerance: B=±1%; G=±2%;
J=±5%; K=±10%;
- (6) Company Code
- (7) Packaging: Tape Carrier Package

◆ **SHAPE AND DIMENSIONS** (unit: mm)

Series	A	B	C	D	E	F	H	I	J
CMCW1005C	1.2 ±0.10	0.60±0.10	0.60±0.10	0.20±0.05	0.50±0.05	0.20±0.05	0.64±0.05	0.40±0.05	0.60±0.05
CMCW1608C	1.68±0.10	1.00±0.10	0.85±0.10	0.32±0.05	0.76±0.05	0.33±0.05	1.02±0.05	0.60±0.05	0.60±0.05
CMCW2012C	2.20±0.10	1.62±0.10	1.45±0.10	0.48±0.05	1.22±0.05	0.45±0.05	1.72±0.05	1.02±0.05	0.76±0.05
CMCW2520C	2.65±0.10	2.60±0.10	2.00±0.10	0.50±0.05	2.05±0.05	0.45±0.05	2.50±0.05	1.02±0.05	1.27±0.05
CMCW3216C	3.46±0.10	2.06±0.10	1.42±0.10	0.50±0.05	1.55±0.05	0.45±0.05	1.88±0.05	1.02±0.05	1.78±0.05
CMCW3225C	3.46±0.10	2.75±0.10	2.60±0.10	0.50±0.05	2.05±0.05	0.45±0.05	2.97±0.05	1.02±0.05	1.78±0.05
CMCW4532C	4.75±0.10	3.71±0.10	3.33±0.10	1.72±0.05	2.85±0.05	0.53±0.05	3.00±0.05	1.14±0.05	3.00±0.05

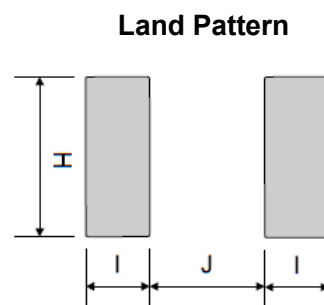
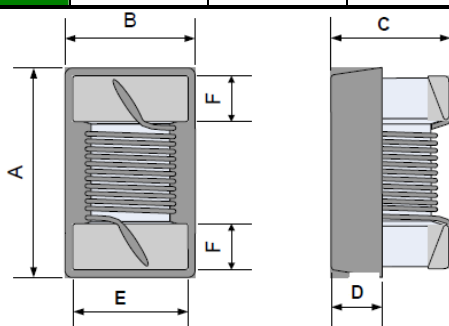

◆ Specifications

Part Number	Inductance	Min. Quality Factor	L/Q Test Condition	Max. DC Resistance	Max. Rated Current	Min. Self-resonant Frequency
	nH	Q	MHZ	Ω	mA	MHZ
CMCW1005C Series						
CMCW1005C0N8◇ST	0.8	14	250	0.025	1000	>6000
CMCW1005C1N5◇ST	1.5	14	250	0.030	1000	>6000
CMCW1005C1N8◇ST	1.8	20	250	0.043	950	>6000
CMCW1005C2N0◇ST	2.0	23	250	0.043	950	>6000
CMCW1005C2N2◇ST	2.2	22	250	0.058	820	>6000
CMCW1005C2N4◇ST	2.4	18	250	0.060	820	>6000
CMCW1005C2N7◇ST	2.7	24	250	0.061	820	>6000
CMCW1005C3N0◇ST	3.0	24	250	0.063	790	>6000
CMCW1005C3N3◇ST	3.3	24	250	0.063	790	>6000
CMCW1005C3N6◇ST	3.6	24	250	0.063	790	>6000
CMCW1005C3N9◇ST	3.9	24	250	0.063	790	>6000
CMCW1005C4N3◇ST	4.3	22	250	0.070	750	>6000
CMCW1005C4N7◇ST	4.7	20	250	0.120	570	>6000
CMCW1005C5N1◇ST	5.1	23	250	0.100	620	>6000
CMCW1005C5N6◇ST	5.6	25	250	0.078	710	>6000
CMCW1005C5N8◇ST	5.8	25	250	0.078	710	>6000
CMCW1005C6N2◇ST	6.2	25	250	0.078	710	>6000
CMCW1005C6N8◇ST	6.8	24	250	0.105	610	6000
CMCW1005C7N5◇ST	7.5	25	250	0.12	570	6000
CMCW1005C8N2◇ST	8.2	25	250	0.11	590	5500
CMCW1005C9N1◇ST	9.1	25	250	0.11	590	5500
CMCW1005C10N◇ST	10	24	250	0.15	510	5500
CMCW1005C11N◇ST	11	26	250	0.12	570	5500
CMCW1005C12N◇ST	12	26	250	0.12	570	5500
CMCW1005C13N◇ST	13	24	250	0.18	460	5000
CMCW1005C14N◇ST	14	26	250	0.21	430	5000
CMCW1005C15N◇ST	15	26	250	0.21	430	5000
CMCW1005C16N◇ST	16	25	250	0.28	370	4500
CMCW1005C18N◇ST	18	25	250	0.28	370	4500
CMCW1005C19N◇ST	19	26	250	0.24	400	4000
CMCW1005C20N◇ST	20	26	250	0.24	400	4000
CMCW1005C22N◇ST	22	25	250	0.36	330	4000
CMCW1005C23N◇ST	23	25	250	0.36	330	3800

◆ Specifications

Part Number	Inductance	Min. Quality Factor	L/Q Test Condition	Max. DC Resistance	Max. Rated Current	Min. Self-resonant Frequency
	nH	Q	MHZ	Ω	mA	MHZ
CMCW1005C Series						
CMCW1005C24N◇ST	24	25	250	0.36	330	3500
CMCW1005C27N◇ST	27	25	250	0.38	320	3500
CMCW1005C30N◇ST	30	25	250	0.38	320	3300
CMCW1005C33N◇ST	33	24	250	0.55	260	3200
CMCW1005C36N◇ST	36	25	250	0.6	250	3100
CMCW1005C38N◇ST	38	25	250	0.6	250	3000
CMCW1005C39N◇ST	39	25	250	0.6	250	3000
CMCW1005C43N◇ST	43	25	250	0.68	240	3000
CMCW1005C47N◇ST	47	25	250	0.95	200	2900
CMCW1005C51N◇ST	51	25	250	0.95	200	2850
CMCW1005C56N◇ST	56	25	250	1.05	190	2800
CMCW1005C62N◇ST	62	25	250	1.05	190	2600
CMCW1005C68N◇ST	68	25	250	1.35	170	2500
CMCW1005C75N◇ST	75	24	250	1.75	140	2400
CMCW1005C82N◇ST	82	25	250	1.9	140	2300
CMCW1005C91N◇ST	91	25	250	1.95	140	2100
CMCW1005CR10◇ST	100	24	250	2.06	130	1500
CMCW1005CR11◇ST	110	25	250	2.38	120	1200
CMCW1005CR12◇ST	120	25	250	2.66	110	1000

◆ Typical Electrical Characteristic

CMCW1005C Series

Inductance vs. Frequency Characteristics

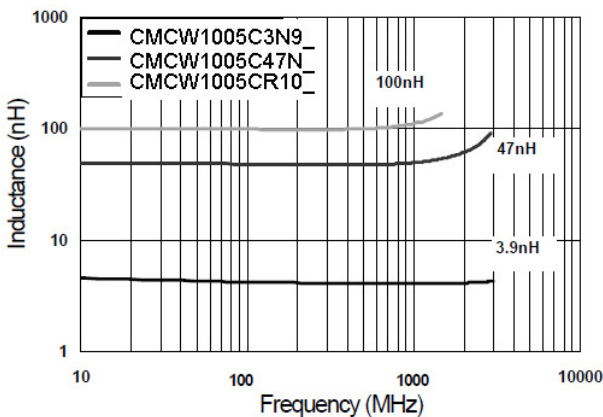

Q vs. Frequency Characteristics

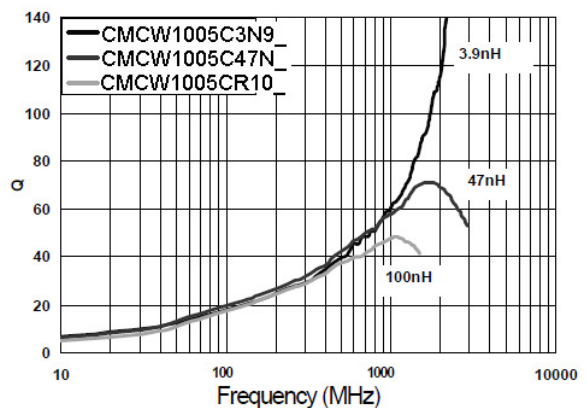

◆Soldering Conditions

**Figure 1.
Re-flow
Soldering (Lead
Free)**

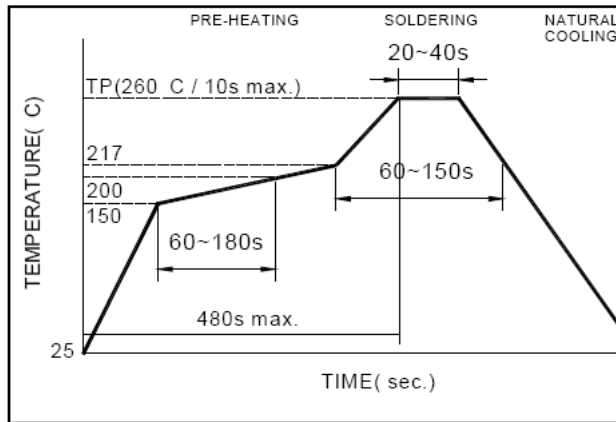

Note:

- Preheat circuit and products to 150°C
- 280°C tip temperature (max)

**Figure 2.
Wave Soldering**

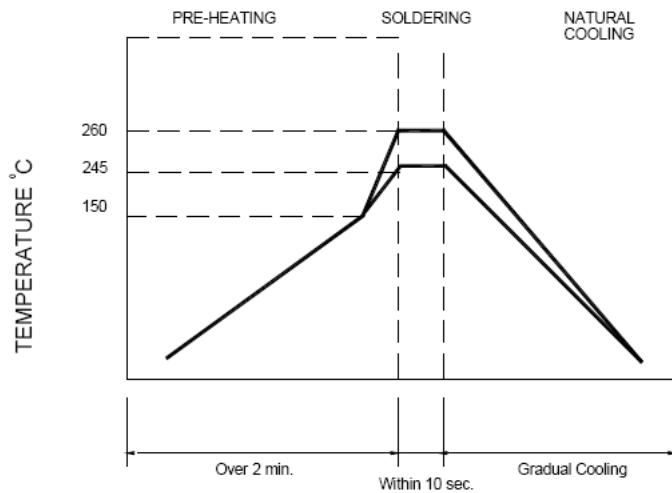

Note :

- Never contact the ceramic with the iron tip
- 1.0mm tip diameter (max)

**Figure 3.
Hand Soldering**

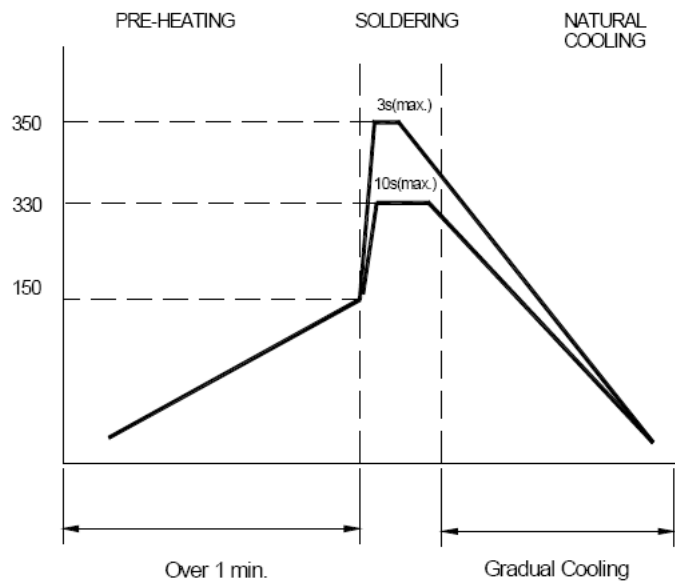

Note:

- Use a 20 watt soldering iron with tip diameter of 1.0mm
- Limit soldering time to 3 sec.

◆ Packaging Style

1、Tape

POLYSTYRENE TAPE

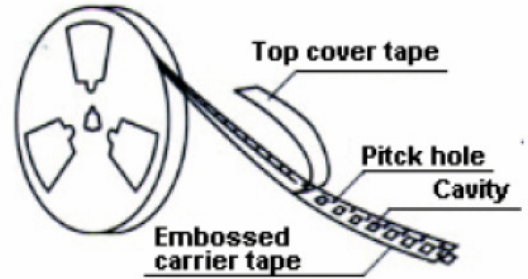
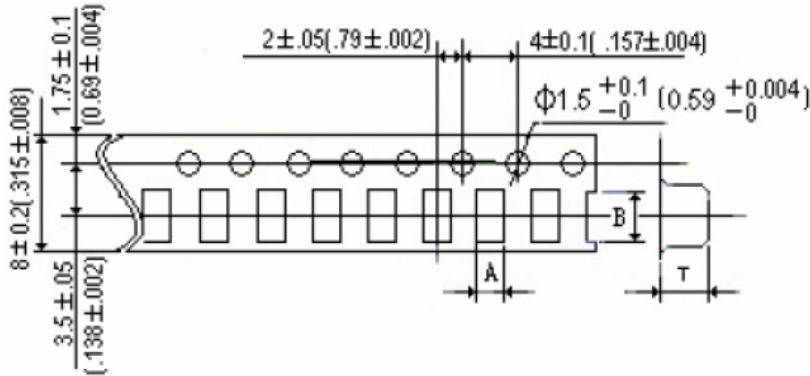

PAPER TAPE

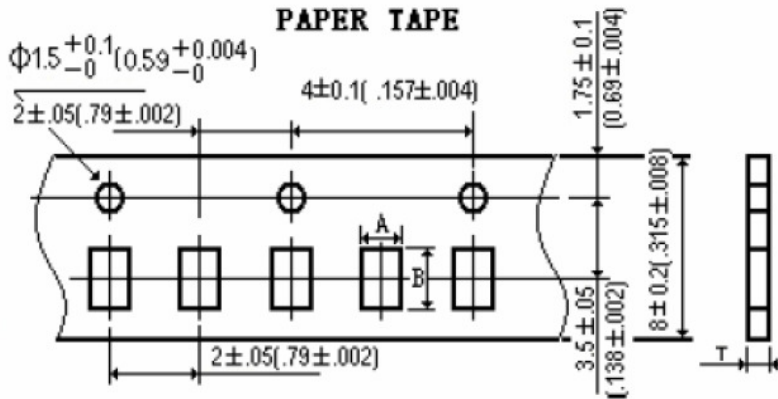

Reel Dimensions

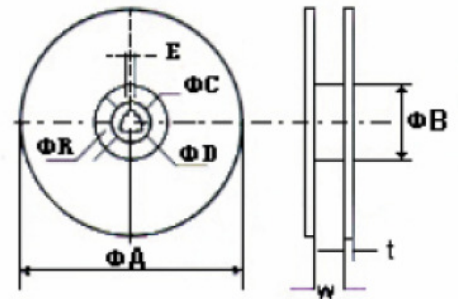

		A	B	T
纸带	0402	0.74	1.23	0.60
胶带	0603	1.15	1.83	0.95
	0805	1.85	2.40	1.45
	1008	2.73	2.90	2.34
	1210	2.96	3.60	2.40
	1812	3.22	4.82	3.15

unit:(mm)

unit	ΦA	ΦB	ΦC	ΦD	E	W	t	R
mm	178	60	13	21	2	10	2	1
	330	75	13	23	2	12	2	1

2、Packaging Quantity

Dimension	1005 (0402)	1608 (0603)	2012 (0805)	2520 (1008)	3225 (1210)	4532 (1812)
Quantity(Pcs)	10000	4000	2000	2000	2000	2000